

THIS DRAWING IS AN UNCONTROLLED COPY UNLESS STAMPED OTHERWISE

CONTRACTORS SHALL VERIFY ALL DIMENSIONS BEFORE ANY WORK COMMENCES. ALL SHOP DRAWINGS SHALL BE SUBMITTED TO THE SUPERINTENDENT AND MANUFACTURE SHALL NOT COMMENCE PRIOR TO THE RETURN OF UNMARKED SHOP DRAWINGS SIGNED BY THE CONSULTANT. FIGURED DIMENSIONS SHALL TAKE PRECEDENCE OVER SCALES. THIS DRAWING SHOULD BE READ IN CONJUNCTION WITH ALL RELEVANT CONTRACT SPECIFICATIONS AND DRAWINGS COPYRIGHT OF THIS DRAWING IS VESTED IN WARDLE

- General Notes
- PERFORATIONS OCCUR IN FOUR SIZES:
    - = DIAMETER OF 10mm
    - = DIAMETER OF 15mm
    - = DIAMETER OF 20mm
    - = DIAMETER OF 25mm
  - ALL DIGITAL ARTWORK FILES WILL BE PROVIDED BY ARCHITECT.
  - CONTRACTORS TO REFER TO RELATED ARCHITECTURAL SPECIFICATION SECTIONS FOR 3D MODEL INTEGRATION REQUIREMENTS.
  - NO VENEER AT EDGE UNLESS OTHERWISE NOTED

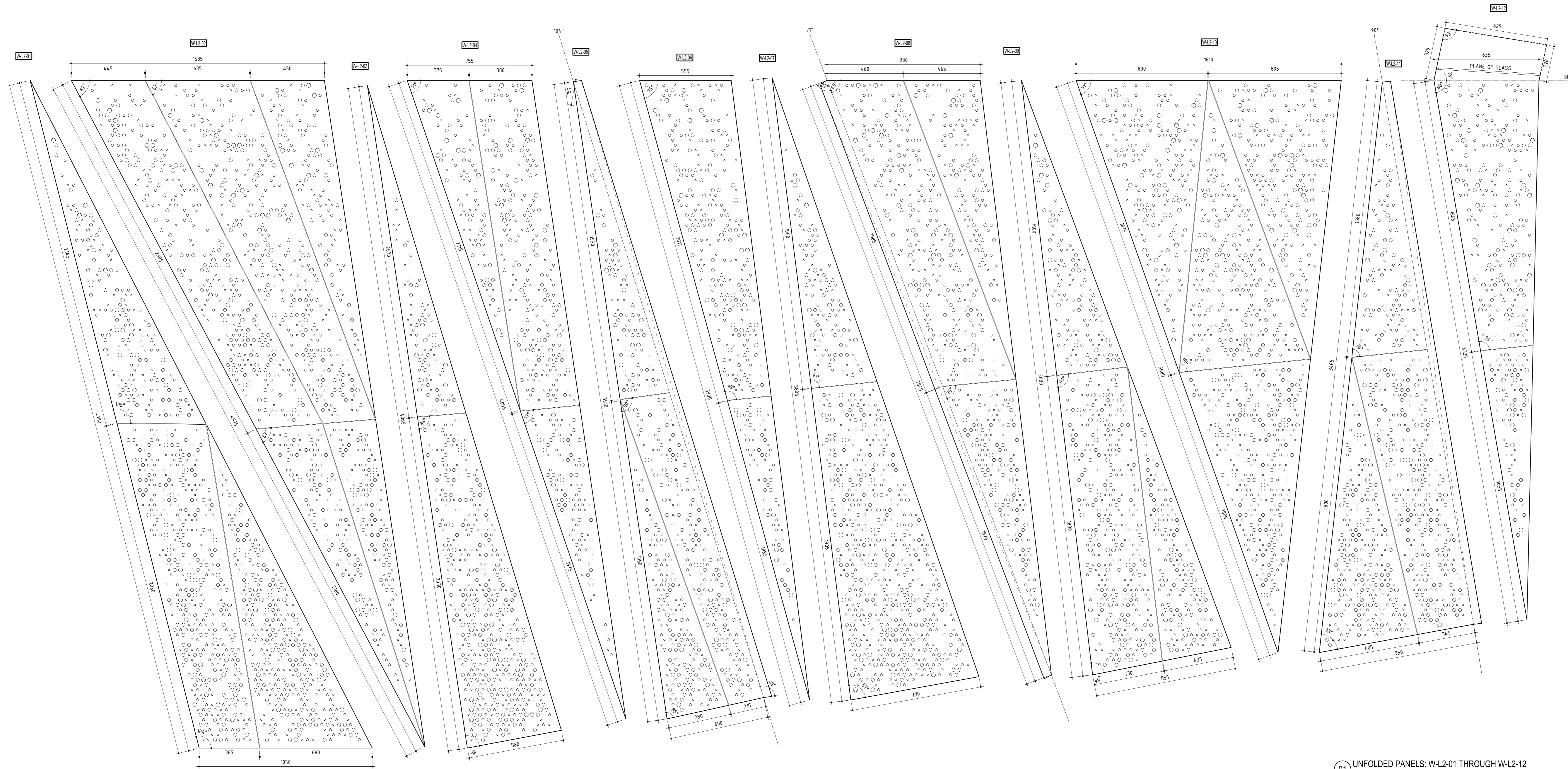

WEST FACE: PANELS W-L2-01 THROUGH W-L2-12

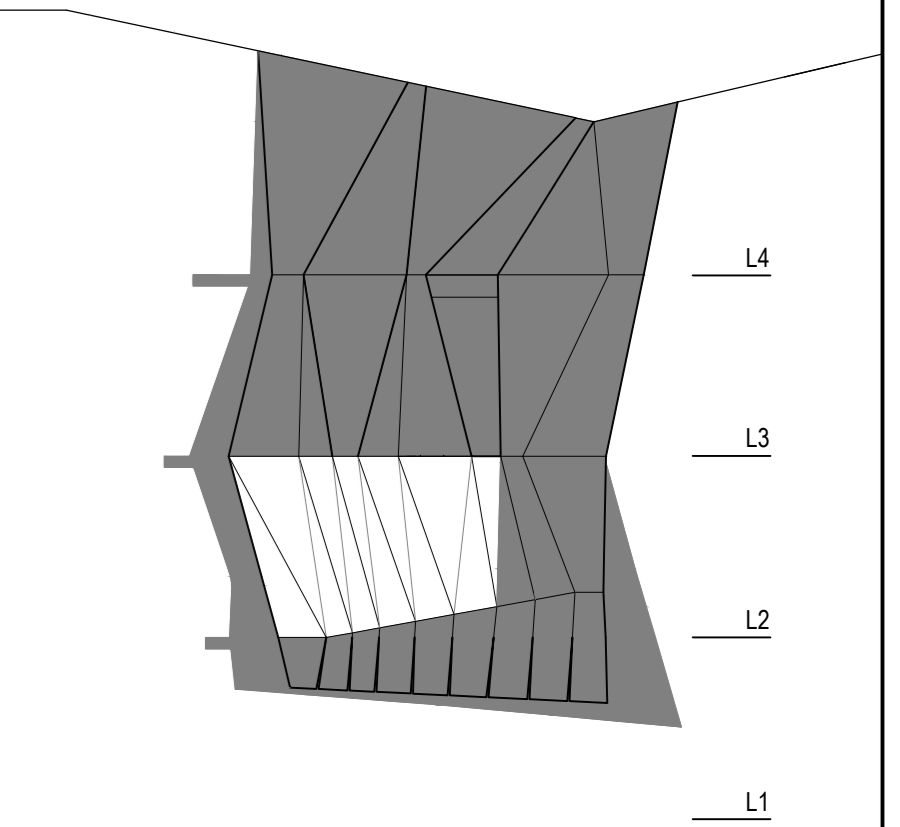

Rev	Issue	Revision Description	Amtd	Date
A	SG	CONSTRUCTION ISSUE	-	06.01.14
D4	JC	100% CD - TENDER ISSUE	-	07.06.12
D3	JC	90% CD ISSUE	-	10.06.12
D2	JC	75% CD ISSUE	-	13.07.12
D1	JC	50% CD ISSUE	-	07.06.12

Rev	Issue	Revision Description	Amtd	Date

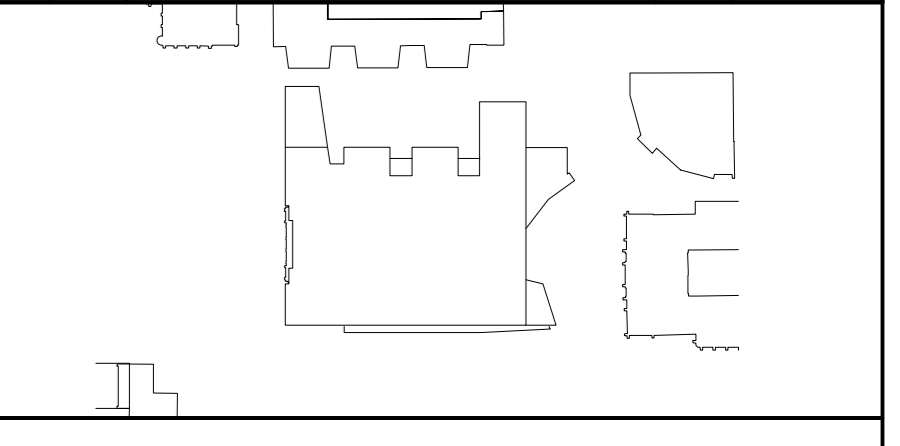

**NADAAA**  
 NADAAA  
 1520 Washington Street No. 2 Boston Massachusetts 02118 USA  
 Telephone: +1 617 442 6332 Facsimile: +1 688 442 1417 Email: nada@nadaaa.com

**John Wardle Architects**  
 © 2011 John Wardle Architects  
 Level 10, 180 Russell Street, Melbourne Victoria 3000 Australia  
 Tel : +613 9654 8700 www.johnwardlearchitects.com

01 UNFOLDED PANELS: W-L2-01 THROUGH W-L2-12  
 SCALE 1:10

Client	University of Melbourne Parkville Campus		
Project	Faculty of Architecture Building and Planning		
Title	HANGING STUDIO UNFOLDED PANELS		
Project No.	0913	Scale	1:10 @ A0 1:20 @ A2
Drawing No.	AR5139	Revision	A
Date	JAN 2014	Dwn	Co-Ord
FILENAME	###		
<b>FOR CONSTRUCTION</b>			